

12 Park Road Kensington Park SA

3 2 2

A home of visual moments to inspire your imagination. Comfortable, spacious, light and bright and definitely original.

Thoughtfully designed to enjoy relaxed family living and for memorable fun entertaining with friends.

Custom built with lots of love for the current owners in December 2016.

So many picture windows overlooking the beautiful landscaped gardens.

So much natural light at all times of the day.

Thanks to the corner allotment the home captures the Northern sun, morning sun rises from the East and wind down sunsets from the West on the upper level.

Generous in size with almost 400m² of total house size. All

Type : House
Price : \$ 3,210,000
Land Size : 547 sqm
View : <https://www.bruse.com.au/sale/sa/eastern-suburbs/kensington-park/residential/house/8000543>

[For full version visit the website](https://www.bruse.com.au)



Theon Bruse
08 8431 8181



Bevan Bruse
08 8431 8181



DOWNSTAIRS

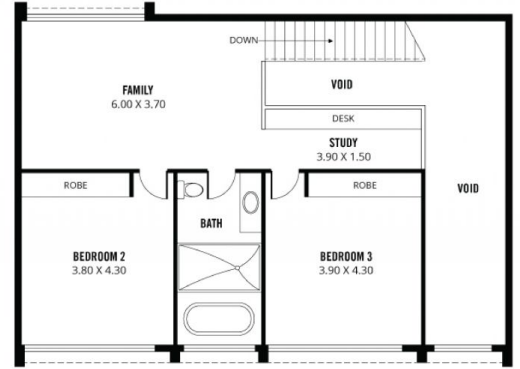

UPSTAIRS

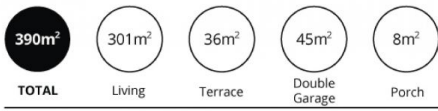

Scale in metres. This drawing is for illustration purposes only. All measurements are approximate and details intended to be relied upon should be independently verified.

Produced by The Fotobase Group