



2/31 Halifax Street Adelaide SA

2 1 1

Entrance to this Nova apartment is from Symonds Place. Nova apartments are part of the Lumiere complex.

This north facing city apartment is both quiet and secure in a central city location. A short walk to Rundle Mall, the Central Market, cafes, restaurants and many other city amenities, it allows full enjoyment of a low maintenance, lock and leave, city lifestyle.

Do not miss this one! It's a rare opportunity in a tightly held group that are quickly snapped up when they come onto the market.

The apartment comprises an entrance area that leads to the lower ground floor area with two good size bedrooms, the main bedroom with a courtyard sky light area, a lovely spot to wake up to in the morning.

Price : \$ 565,000

View : <https://www.bruse.com.au/sale/sa/adelaide/adelaide/residential/apartment/7784173>



Bevan Bruse
08 8431 8181



Theon Bruse
08 8431 8181

1st Floor

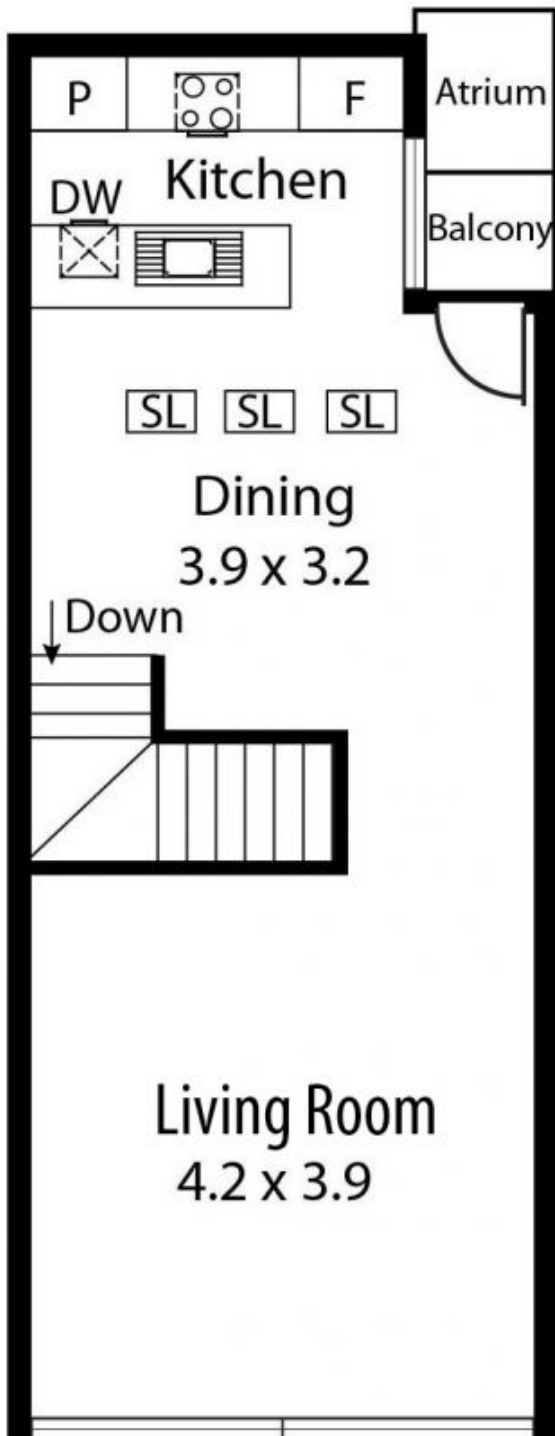

Lower Level

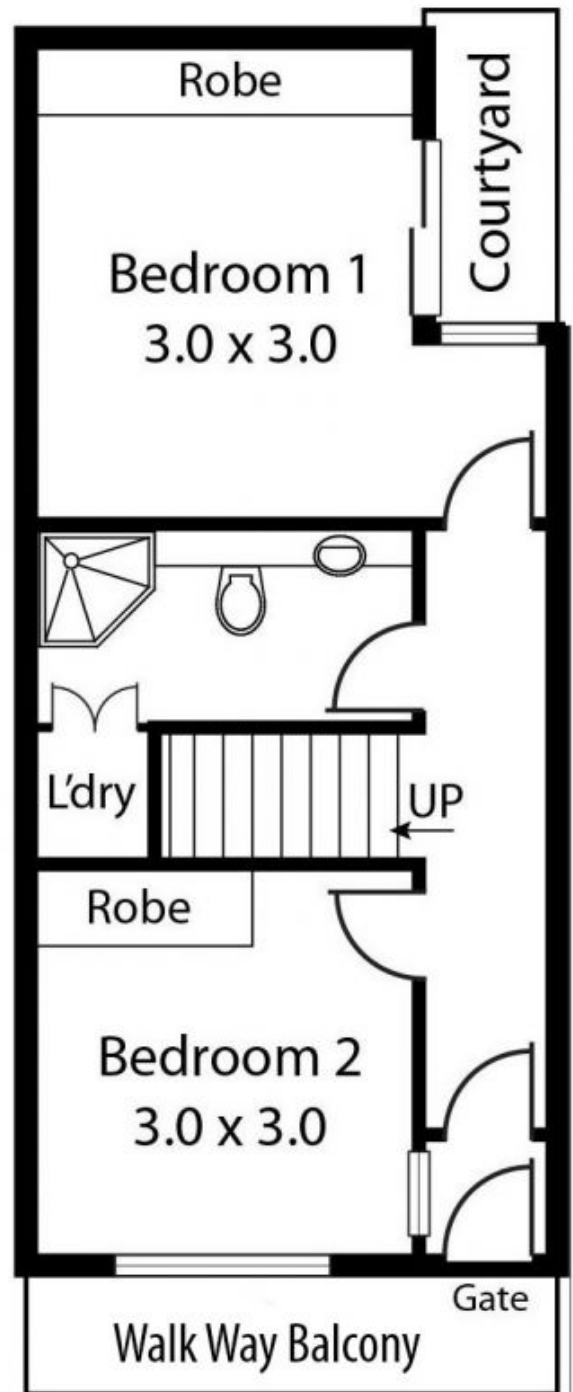

This floorplan is for illustration purposes only and all measurements are approximate. Any fixtures shown may not necessarily be included in the sale contract and is essential that any queries are directed to the agent. Any information that is intended to be relied upon, should be independently verified. Neither the agent, vendor or contracted illustrators take any responsibility of any omission, wrongful inclusion or topographical error which may occur in this drawing as it is an artistic impression only. While every endeavor has been made to verify the correct details in the publication, neither the agent, vendor nor contracted typesetter accept liability for any error or omission.

SYMONDS PLACE

HALIFAX STREET

HOWARD FLOREY STREET

