

**Sold First Week!
14 Buyers Missed Out**



27 Hutchinson Avenue Athelstone SA

3 1 2

This is an amazing location, great opportunity for any buyer seeking to purchase a home in an attractive price range in this marvelous location.

This home includes an entrance hallway that leads to a very generous open plan living and dining area, this dining area also opens out to the outdoor living area and there is a centrally located kitchen with quality fixtures and fittings, ample cupboard and bench space and a walk in pantry.

This room is adjacent to the family living room with direct access out to the large undercover outdoor living area.

The home has three good size bedrooms, the main bedroom to the front of the residence includes access to the two-way bathroom and also includes large built-in robe.

Price : \$ 705,000
Land Size : 595 sqm
View : <https://www.bruse.com.au/sale/sa/north-north-east-suburbs/athelstone/residential/house/7423837>



Bevan Bruse
08 8431 8181



Theon Bruse
08 8431 8181

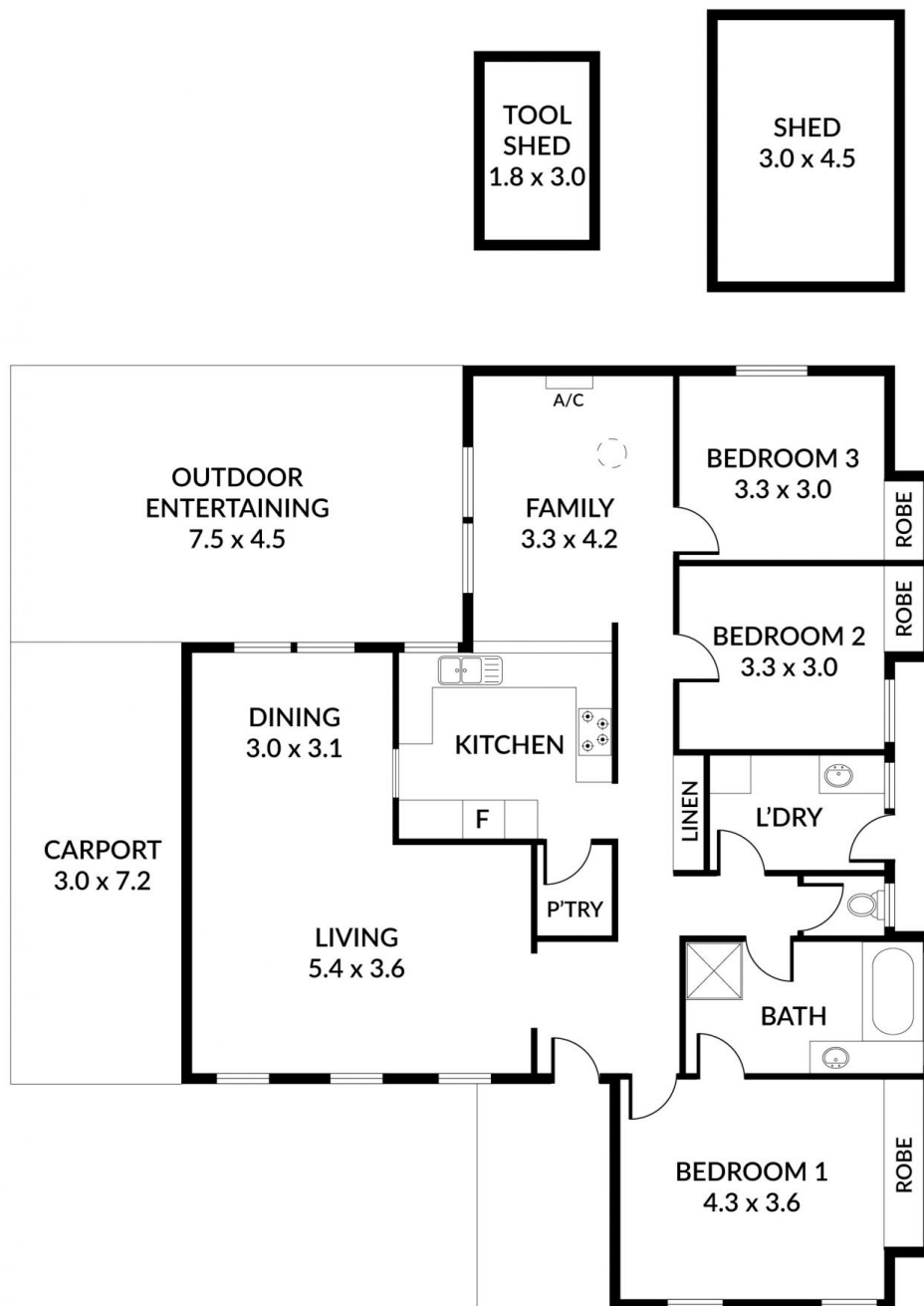

Scale in metres. Indicative only. Dimensions are approximate. All information contained herein is gathered from sources we believe to be reliable. However we cannot guarantee its accuracy and interested persons should rely on their own enquiries

