



1/15 Dawn Avenue Hectorville SA

3 2 2

BUYERS WILL APPRECIATE THE EFFORT AND ATTENTION TO DETAIL THAT THE CURRENT OWNERS HAVE PUT INTO THIS HOME WHEN THEY CHOSE THE INTERIOR SELECTIONS. ULTRA MODERN BUT WITH A WARM HOMELY FEEL ABOUT IT.

Price : \$ 762,500

View : <https://www.bruse.com.au/sale/sa/eastern-suburbs/hectorville/residential/house/7371509>

So much natural light thanks to the street front position and wide design that allows for extra large windows. Even each of the 3 bedrooms are complimented with a lovely urban outlook.

TWO SEPARATE LIVING ROOMS

The hub of the home open plan everyday living and dining space flows seamlessly out to the outdoor entertaining area and is adjacent the generous fully equipped kitchen. Superb for entertaining or just relaxing at home with your



Theon Bruse
08 8431 8181



Bevan Bruse
08 8431 8181

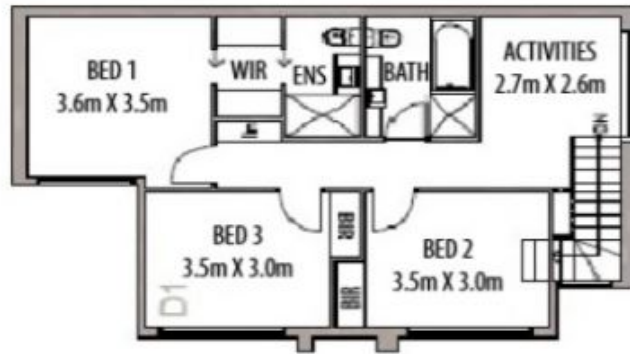

FIRST FLOORPLAN

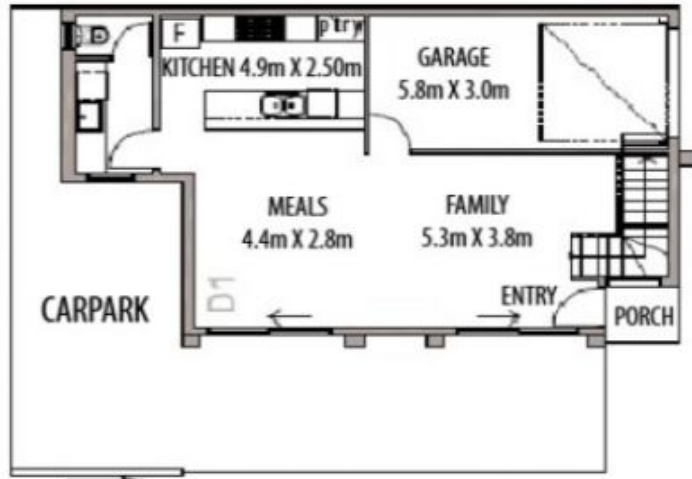

GROUND FLOORPLAN

TOTAL HOUSE SIZE 180.3m²