



586 Glynburn Road Beaumont SA

3 2 3

THIS HOME HAS BEEN METICULOUSLY MAINTAINED BY THE CURRENT OWNER FOR A NUMBER OF YEARS AND HAS BEEN TOTALLY UPGRADED, 2 ALL NEW STUNNING BATHROOMS, STUNNING NEAR NEW KITCHENS, FLOOR COVERINGS, TIMBER FLOORING AND RECENTLY REPAINTED BOTH INSIDE AND OUT.

Price : \$ 1,387,500
Land Size : 807 sqm
View : <https://www.bruse.com.au/sale/sa/eastern-suburbs/beaumont/residential/house/7348882>

This home is built on the high side of the road giving excellent views and also a commanding look when approaching the home.

The external wrought iron staircase leads to the foyer and entrance of the residence.

The entrance hall of the home leads to the main bedroom suite with upgraded ensuite facility with frameless shower screen, quality tiling and all new fittings and fixtures. This



Bevan Bruse
08 8431 8181



Theon Bruse
08 8431 8181

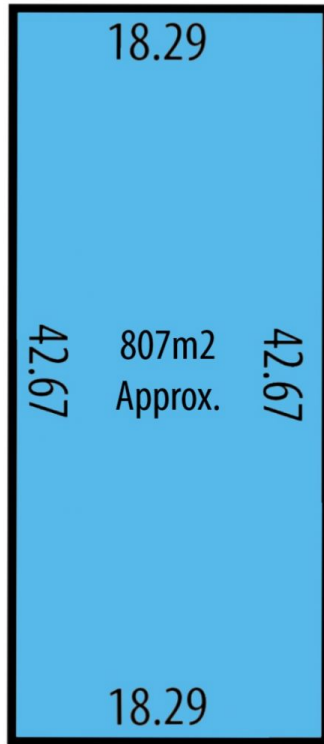

GLYNBURN ROAD

(NOT IN POSITION)

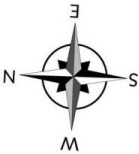
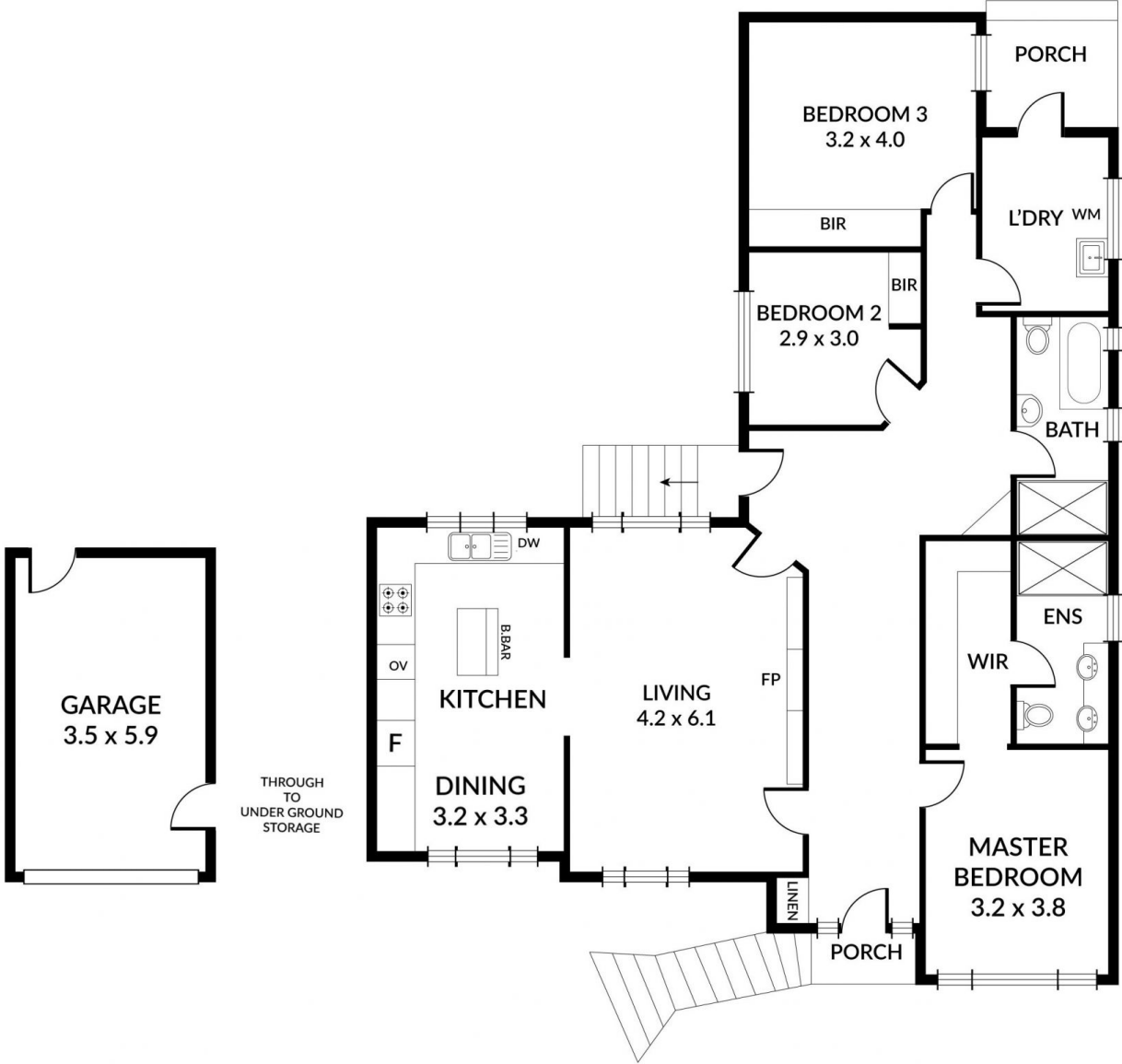

Scale in metres. Indicative only. Dimensions are approximate. All information contained herein is gathered from sources we believe to be reliable. However we cannot guarantee its accuracy and interested persons should rely on their own enquiries