

22C Patola Place Magill SA

3 2 2

BUYERS LOOKING FOR A GOOD SIZE HOME WITH STUNNING INTERIOR DESIGN WILL LOVE THIS HOME. EASY CARE LIVING AT ITS BEST. ITS ALL ABOUT THE LIFESTYLE OF THE EASTERN SUBURBS.

Price : \$ 725,000

View : <https://www.bruse.com.au/sale/sa/eastern-suburbs/magill/residential/house/6902793>

Short walk to the park and playground.
Norwood Morialta High School Zone!
Lock up garage plus second carport.
Quiet no through culdesac location.
Over 200m² of total house size.
2 light & bright living areas.
Stunning chef ready kitchen complete with solid stone bench tops & SMEG appliances.
Powder room/ 3rd toilet on the ground level.
3 bedrooms & 2 luxurious bathrooms.
Excellent storage.
Under cover outdoor alfresco entertaining area.



Theon Bruse
08 8431 8181



Bevan Bruse
08 8431 8181

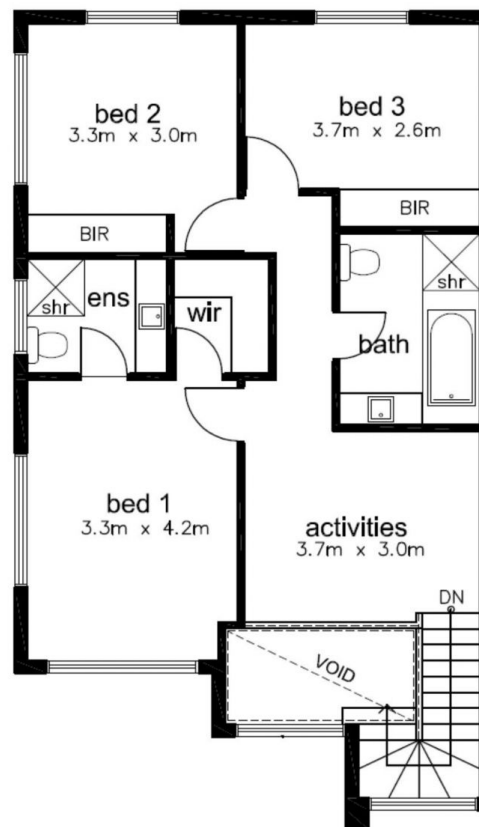
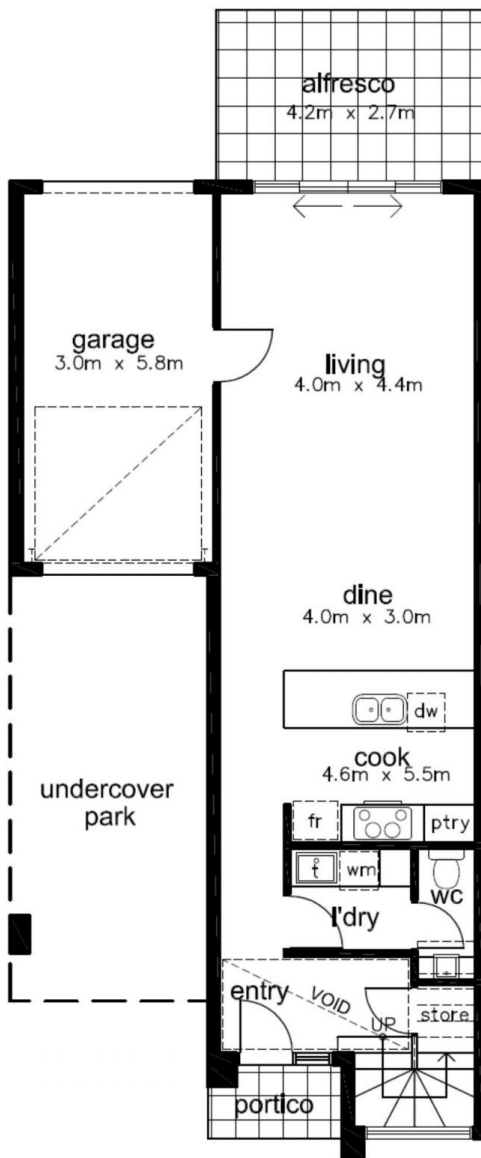

GROUND FLOOR PLAN

DWELLING 6

UPPER FLOOR PLAN

DWELLING 6

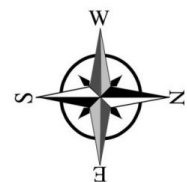

AREAS (sqm)

22C Patola Place, Magill

GROUND MAIN LIVING	UPPER MAIN LIVING	GARAGE	PORTICO	ALFRESCO	UNDERCOVER PARK	TOTAL
62.00	84.00	19.80	02.50	11.50	21.00	200.80

NOTE: THIS PLAN / DOCUMENT IS FOR ILLUSTRATION PURPOSES ONLY. ALL DIMENSIONS ARE APPROXIMATE. WHILE EVERY ENDEAVOUR HAS BEEN MADE TO VERIFY THE CORRECT DETAILS NEITHER THE VENDOR, THE AGENT, NOR THE DESIGNER ACCEPT LIABILITY FOR ERROR OR OMISSION