



**1B Douglas Grove Glenelg North SA**

3 2 1

BUYERS LOOKING FOR A NEAR NEW DESIGNER HOME CLOSE TO THE BEACH WILL APPRECIATE THIS ONE. THE ATTENTION TO DETAIL OF THE INTERIOR DESIGN & QUALITY IS STUNNING.

**Price** : \$ 741,500

**View** : <https://www.bruse.com.au/sale/sa/western-beach-side-suburbs/glenelg-north/residential/house/6833224>

Torrens Title.

Superb light & bright open plan living and dining room.

Excellent flow from the internal to the outdoor entertaining area.

Stunning kitchen complete with beautiful custom joinery and stone benchtops. High-end appliances and an abundance of workspace.

Undercover outdoor alfresco area.



**Theon Bruse**  
08 8431 8181



**Bevan Bruse**  
08 8431 8181

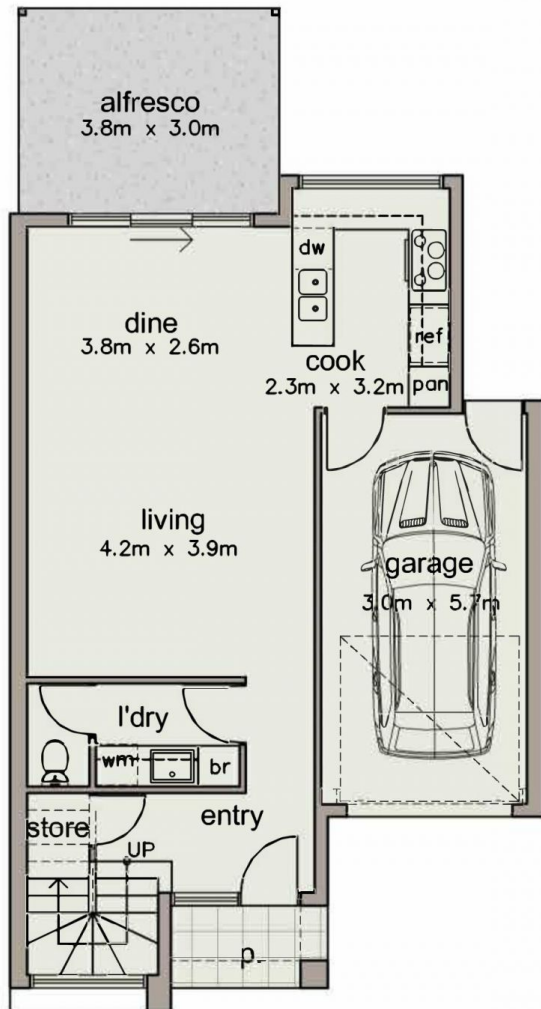

GROUND FLOOR PLAN

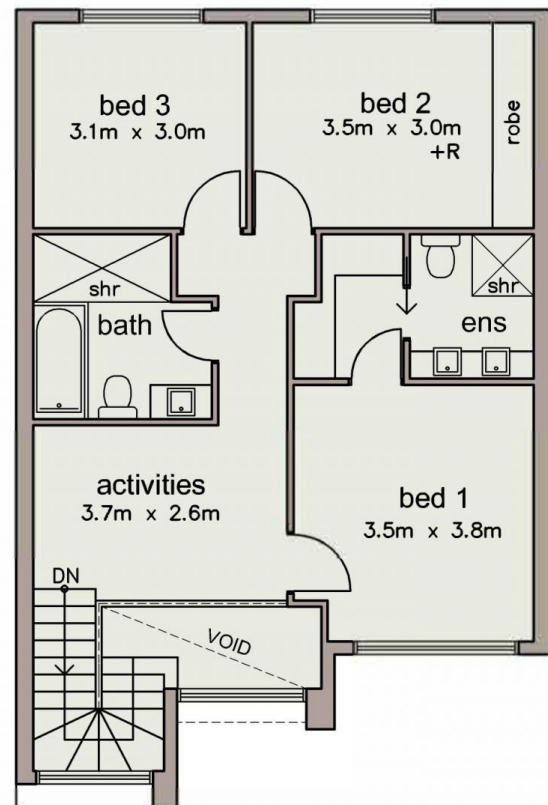

UPPER FLOOR PLAN

AREAS (sqm)

GROUND MAIN LIVING	UPPER MAIN LIVING	GARAGE	PORTICO	ALFRESCO	TOTAL
55.00	77.00	18.70	02.70	11.40	164.80

NOTE: THIS PLAN / DOCUMENT IS FOR ILLUSTRATION PURPOSES ONLY. ALL DIMENSIONS ARE APPROXIMATE. WHILE EVERY ENDEAVOUR HAS BEEN MADE TO VERIFY THE CORRECT DETAILS NEITHER THE VENDOR, THE AGENT, NOR THE DESIGNER ACCEPT LIABILITY FOR ERROR OR OMISSION