



10/3 Church Road Paradise SA

2 1 1

This unit is in a very attractive group. Close to all conveniences, excellent shopping and transport.

This is an opportunity to live in an excellent secure group on the upper level with great views from the living room, bedrooms and balcony.

The unit has a very nice feel about it. Being the end unit, nobody walks past your doors or windows and it has a feeling of space from the moment you enter the home.

The kitchen, dining and living area is an open plan room and this generous room allows for buyers to entertain in the unit as it is generous in size and has direct access out to the balcony at the front of the home.

The home unit also includes 2 very good size bedrooms,

Price : \$280,000-\$290,000
View : <https://www.bruse.com.au/6421605>



Bevan Bruse
08 8431 8181



Theon Bruse
08 8431 8181



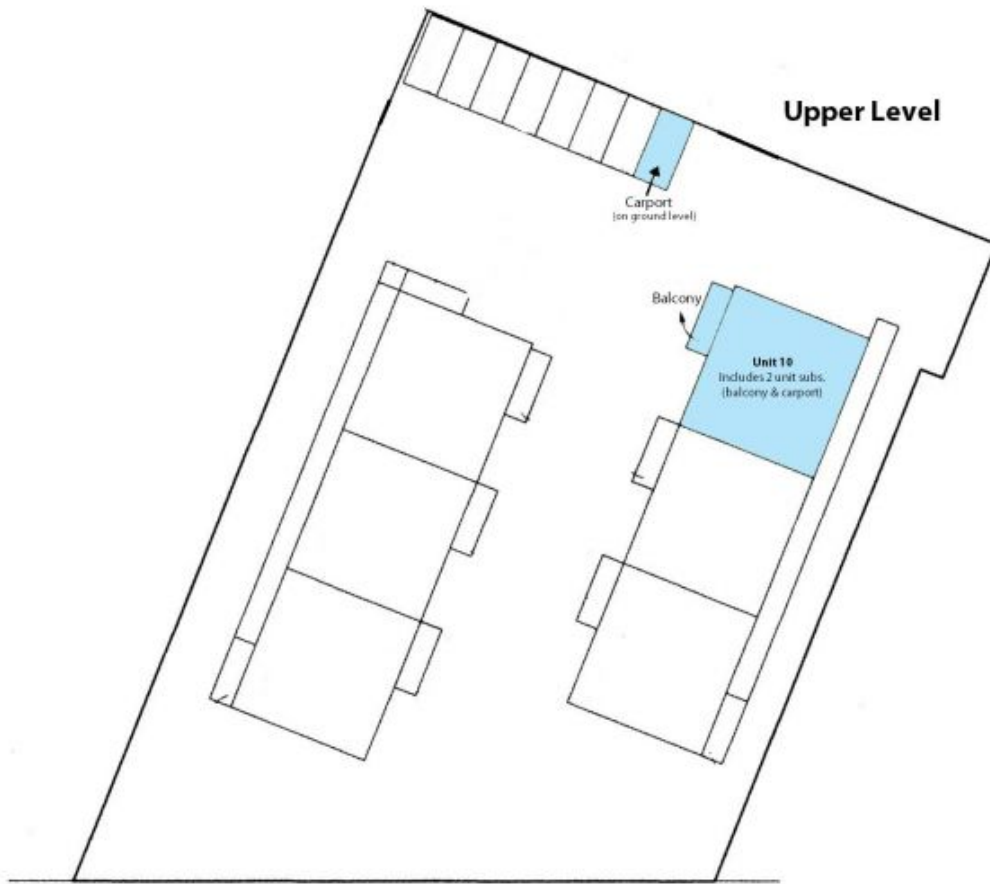

Upper Level

Carport
(on ground level)

Balcony

Unit 10
Includes 2 unit subs.
(balcony & carport)

C H U R C H R O A D