



Res 10/1111 North East Road Ridgehaven SA

3 1 2

THIS AMAZING TOWNHOME OFFERS THE OPPORTUNITY TO BE IN FRONT OF THE GROUP AND INCLUDES AN ENORMOUS AMOUNT OF YARD SPACE BELONGING TO THE TITLE OF THIS TOWNHOME.

The home includes an entrance hallway that leads to a good size front sitting room, measuring some 4.6m x 3.5m. The lower level also includes a dining area adjacent to a very well-appointed kitchen with quality fixtures and fittings and the dining area leads out to a pergola area at the rear of the home. The pergola area overlooks an attractive garden setting and has direct access to the garage of the home.

The land to the side of the pergola and to the side of the home has an enormous amount of land holding that you can SEE ON THE SITE PLAN OF THE HOME. THIS IS

Price : \$ 415,000

View : <https://www.bruse.com.au/sale/sa/north-north-east-suburbs/ridgehaven/residential/house/6324072>



Bevan Bruse
08 8431 8181



Theon Bruse
08 8431 8181

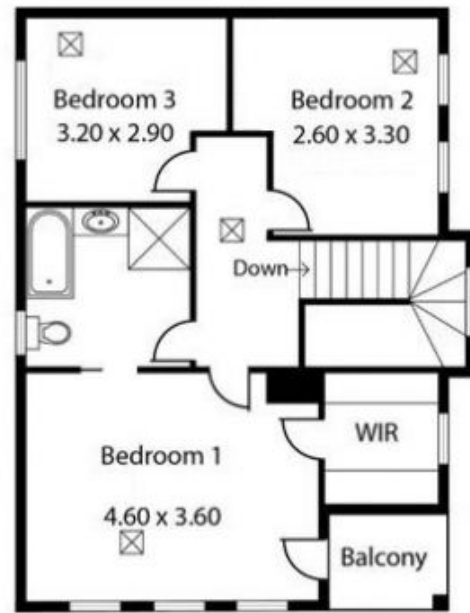

UPPER LEVEL



LOWER LEVEL

Living:	125.34 sqm
Porch:	3.42 sqm
Balcony:	3.42 sqm
Pergola:	7.84 sqm
Garage:	22.05 sqm
Total:	162.07 sqm



This Drawing is for illustration purposes only.
All measurements are internal and approximate.
Details intended to be relied upon should be
independently verified.

