



1B Douglas Grove Glenelg North SA

3 2 1

**** OPEN INSPECTION TO BE CONFIRMED****

Near new Torrens Title town house. Move in NOW and enjoy!

ARCHITECTURALLY DESIGNED FOR A STYLISH MODERN LOOK.

LUXURIOUS INTERIORS DESIGNED BY A PROFESSIONAL INTERIOR DESIGNER.

Disclaimer: The furniture and effects in the photos will be removed prior to a new tenancy.

The location is fantastic. Only located just over a 1km walk to the beach and vibrant Jetty Road with an array of cafes, restaurants, shopping and a cinema. Bayside village shopping centre with Woolworths, local gym, butcher and other specialty shops are also within walking distance.

View : <https://www.bruse.com.au/6249029>

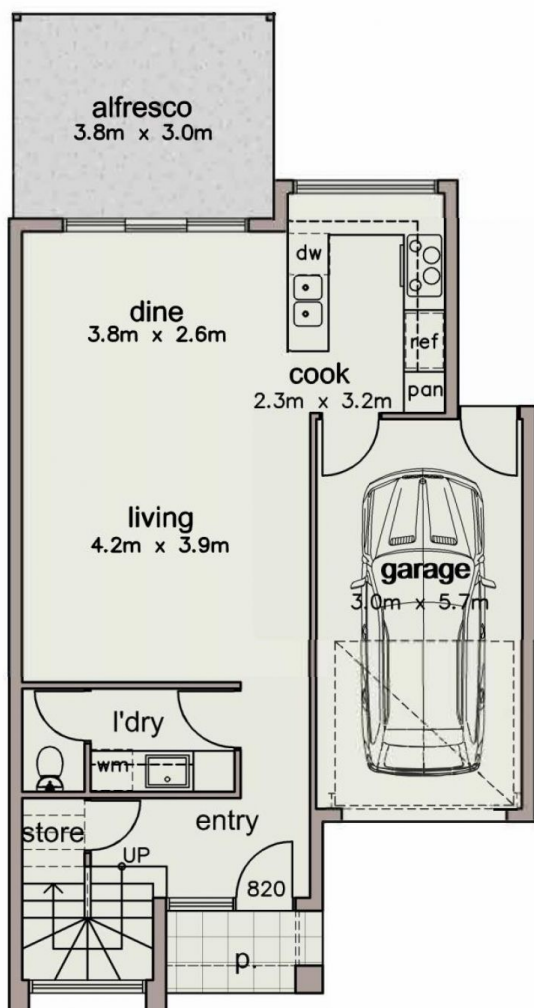

GROUND FLOOR PLAN

DWELLING 4

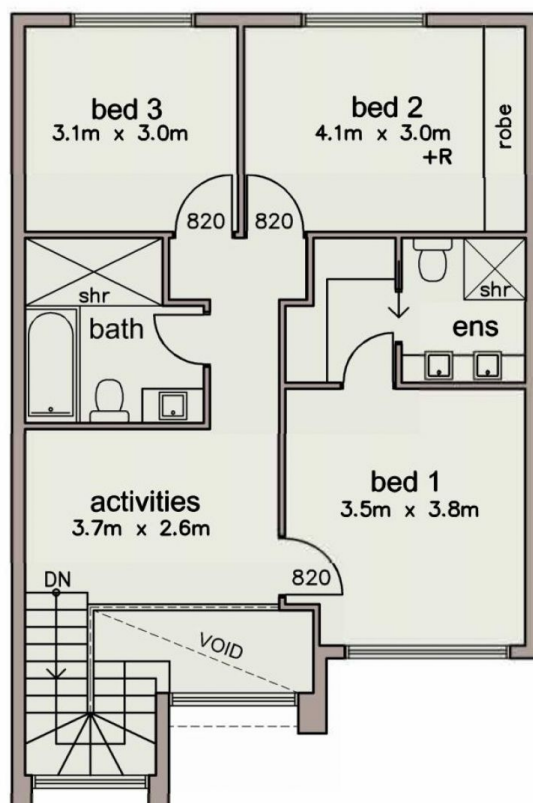

UPPER FLOOR PLAN

DWELLING 4

AREAS (sqm)

GROUND MAIN LIVING	UPPER MAIN LIVING	GARAGE	PORTICO	ALFRESCO	TOTAL
55.00	77.00	18.70	02.70	11.40	164.80

NOTE: THIS PLAN / DOCUMENT IS FOR ILLUSTRATION PURPOSES ONLY. ALL DIMENSIONS ARE APPROXIMATE. WHILE EVERY ENDEAVOUR HAS BEEN MADE TO VERIFY THE CORRECT DETAILS NEITHER THE VENDOR, THE AGENT, NOR THE DESIGNER ACCEPT LIABILITY FOR ERROR OR OMISSION