

## 46 Kennaway Street Tusmore SA

3 2 4

A RARE FIND IN AN AMAZING STREET, CLOSE TO MANY PARKS AND RESERVES. THIS CLASSIC TUDOR HOME WILL SUIT THE BUYER WHO WANTS TO MOVE IN, LIVE AND ENJOY AN EXTREMELY WONDERFUL LIFE. IT HAS BEEN METICULOUSLY MAINTAINED BY THE CURRENT OWNERS WHO HAVE CARED FOR THIS HOME EXTREMELY WELL IN THE MANY YEARS THEY HAVE LIVED THERE.

This home has a character entrance hallway. The entrance hallway leads to the formal sitting room and formal dining room of the home, these very ornate character rooms certainly are a feature of the residence but can be used for many purposes. Both have ornate ceilings and fireplaces.

The solid timber floors throughout these rooms are jarrah and are in impeccable condition.

**Price** : \$ 1,450,000  
**Land Size** : 766 sqm  
**View** : <https://www.bruse.com.au/6195822>



**Bevan Bruse**  
08 8431 8181



**Theon Bruse**  
08 8431 8181

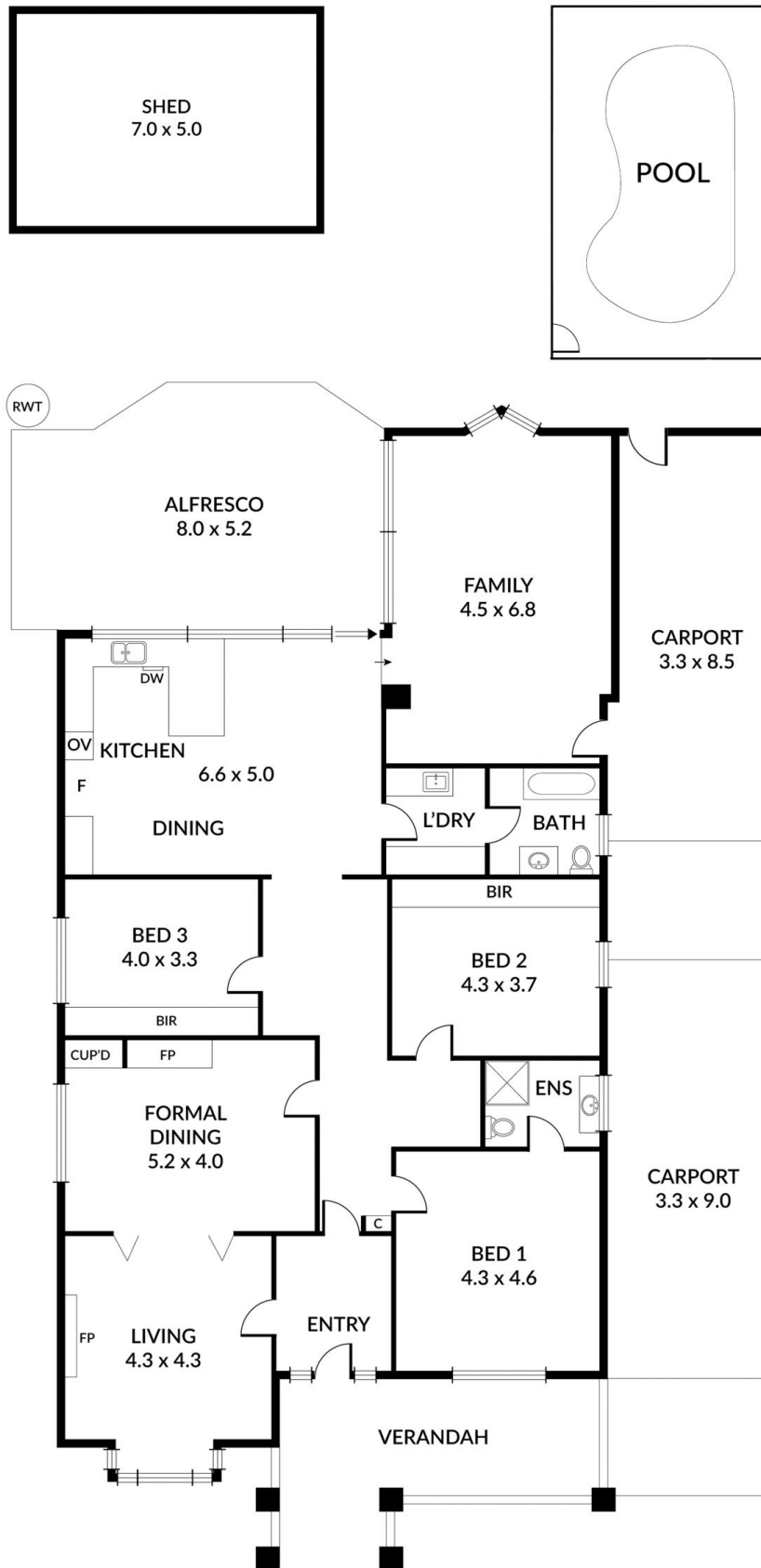

LIVING	202M <sup>2</sup>
CARPORT	59M <sup>2</sup>
VERANDAH	29M <sup>2</sup>
ALFRESCO	38M <sup>2</sup>
SHED	35M <sup>2</sup>
<b>TOTAL</b>	<b>363M<sup>2</sup></b>

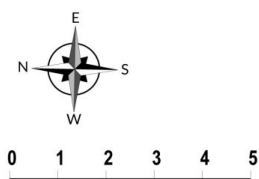

Scale in metres. Indicative only. Dimensions are approximate. All information contained herein is gathered from sources we believe to be reliable. However we cannot guarantee its accuracy and interested persons should rely on their own enquiries

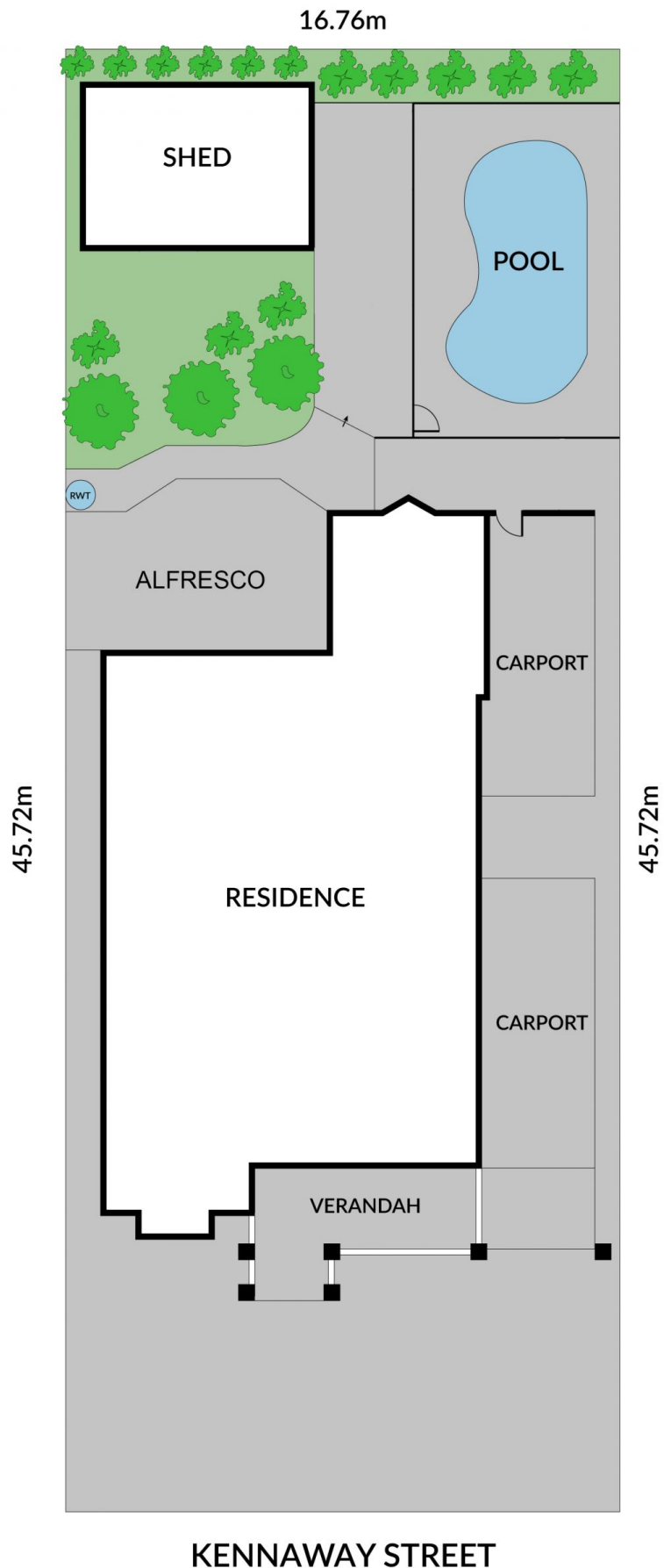

Scale in metres. Indicative only. Dimensions are approximate. All information contained herein is gathered from sources we believe to be reliable. However we cannot guarantee its accuracy and interested persons should rely on their own enquiries.