



**4/36 Dashwood Road Beaumont SA**

2 1 1

THIS IS A LOVELY UNIT IN A BEAUTIFUL AND PEACEFUL LOCATION. IT IS THE END UNIT IN A SMALL GROUP OF 4. FACING ATTRACTIVE TREE LINED MILTON AVENUE.

**Price** : \$ 515,000

**View** : <https://www.bruse.com.au/sale/sa/eastern-suburbs/beaumont/residential/unit/5880594>

THANKS TO THE WIDE FRONTAGE AND BEING STREET FACING THE HOME HAS A LOVELY OUTLOOK AND ATTRACTS AN ABUNDANCE OF NATURAL LIGHT. WHEN YOU VISIT THE PROPERTY YOU WILL FIND IT HAS A GREAT FEEL ABOUT IT.

STYLISHLY RENOVATED THROUGHOUT.

The quality and tasteful design will be appreciated by the most fastidious buyers.

Luxurious bathroom.

Fully equipped kitchen.

Stunning polished timber floors.



**Theon Bruse**  
08 8431 8181



**Bevan Bruse**  
08 8431 8181

Living:	84.35 sqm
Verandah:	11.36 sqm
Carport:	15.96 sqm
Total:	111.67 sqm

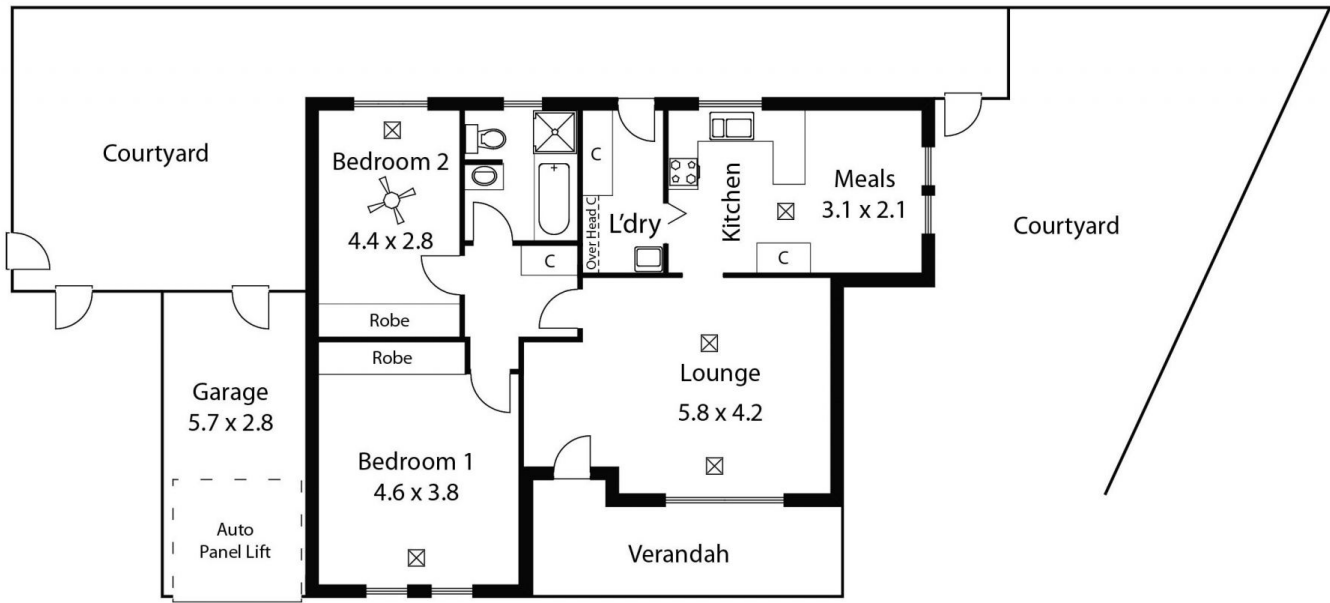

DASHWOOD ROAD

MILTON AVENUE

