



6/ Ivy Street Hampstead Gardens SA

Irregular 559.5m² (approx.) with 1 frontage of 33.1m.

This home has been lived in for many years by the one owner and the home is now vacant and in a poor shape where you can do a restoration, renovation very quickly to the home and move in and live.

OR

A great development site in a stunning location.

THIS LOCATION IS UNBELIEVABLE AS IT IS OPPOSITE A PARK IN A VERY QUIET LOCATION, JUST OFF OF WAYS ROAD. THIS IS REALLY ONE OF THOSE PRIME SPOTS TO DEVELOP LAND OR BUILD A GREAT HOME ON AND ENJOY THE WONDERFUL FINANCIAL RETURNS OR ENJOY THE LIFESTYLE OF THE AREA FOR YOUR OWN PERSONAL USE. DO NOT MISS OUT. THIS IS A RARE FIND.

Price : \$ 377,000
Land Size : 559 sqm
View : <https://www.bruse.com.au/sale/sa/north-north-east-suburbs/hampstead-gardens/residential/land/5770217>



Bevan Bruse
08 8431 8181



Theon Bruse
08 8431 8181

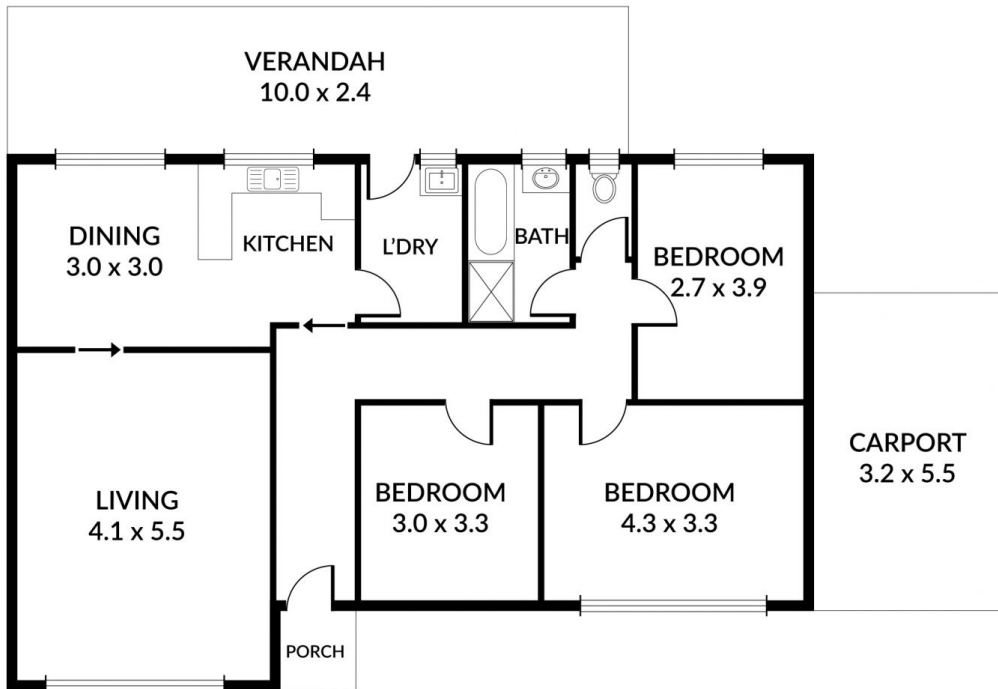

| | |
|--------------|---------------------------|
| LIVING | 100M ² |
| CARPORT | 17.6M ² |
| VERANDAH | 24M ² |
| SHED | 6.2M ² |
| TOTAL | 147.8M² |

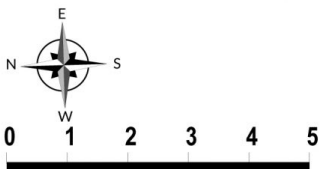

Scale in metres. Indicative only. Dimensions are approximate. All information contained herein is gathered from sources we believe to be reliable. However we cannot guarantee its accuracy and interested persons should rely on their own enquiries



IVY STREET