



**20, 25 & 26 Chapel Way (off Of Swan Ave) Rostrevor SA**

**3** **2** **2**

NOW COMPLETE AND READY TO MOVE INTO,  
PRICED BETWEEN \$595,000-\$605,000

**Price** : \$595,000 - \$605,000

**View** : <https://www.bruse.com.au/5714242>

FOR OPEN INSPECTIONS, PLEASE MEET BEVAN BRUSE AT HOUSE NUMBER 31. PLEASE REFER TO SITE PLAN FOR MAP AND MEETING PLACE.

Number 31 is now complete for you to see a finished display home.

Also house number 24 overlooks the Morialta Reserve and is fully furnished as a second display home.

EACH HOME IS BUILT ON THREE LEVELS WITH DOUBLE LENGTH GARAGE ON LOWER LEVEL.

A NUMBER OF THESE HOMES ARE NOW COMPLETE



**Bevan Bruse**  
**08 8431 8181**



**Theon Bruse**  
**08 8431 8181**

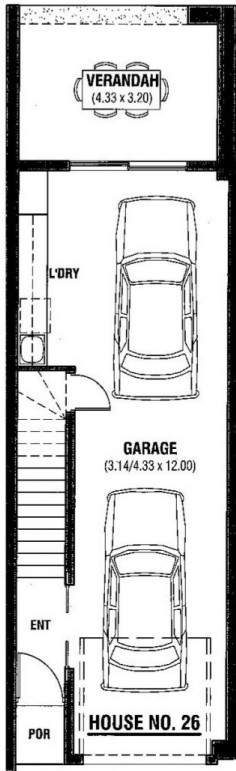

**GROUND FLOOR PLAN**

SCALE 1:100

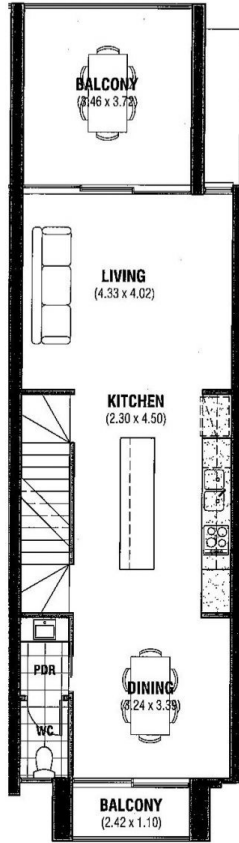

**FIRST FLOOR PLAN**

SCALE 1:100

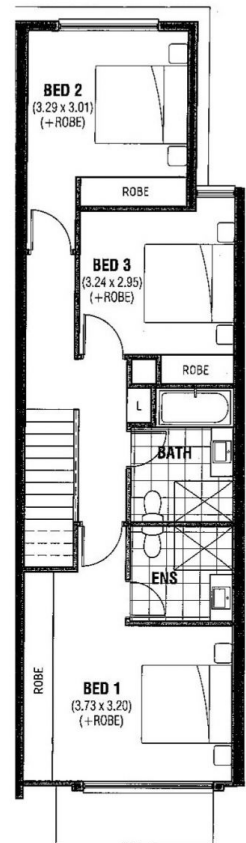

**SECOND FLOOR PLAN**

SCALE 1:100

AREAS (NO. 26)	sq.m
GROUND FLOOR/GARAGE	55.55
FIRST FLOOR LIVING	56.87
SECOND FLOOR LIVING	69.20
VERANDAH	14.72
BALCONY (REAR)	14.38
BALCONY (FRONT)	3.56
PORCH	1.38
<b>TOTAL</b>	<b>215.66</b>

**STRADBROKE ROAD  
(OVERLOOKING MORIALTA RESERVE)**

**House No 20 - 27**

**Please come to home No. 25  
in the group for inspections.**

**House  
No  
28 - 35**

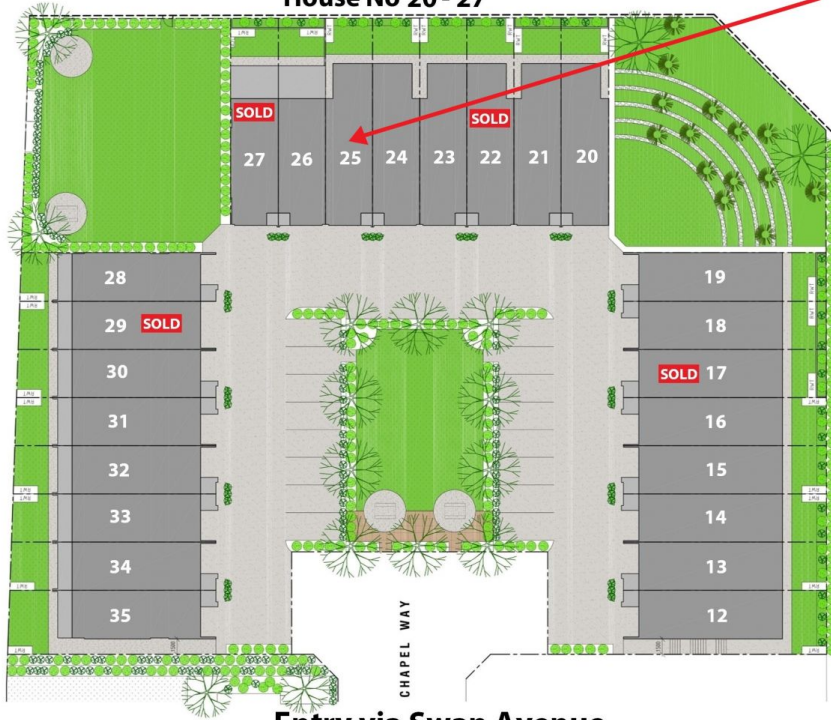

**MORIALTA ROAD**

**House  
No  
12 - 19**

**Entry via Swan Avenue**

