



24 Gleneagles Road MOUNT OSMOND SA

3 2 2

This is an excellent home on a good size allotment of 1,910m² (30.48m x 63.02m), backing onto the golf course.

View : <https://www.bruse.com.au/sale/sa/eastern-suburbs/mount-osmond/residential/house/5550761>

Excellent views over a tranquil setting makes this is a great lifestyle for many buyers seeking to acquire an excellent home in close proximity to the city centre, yet a feeling of living in the countryside.

This is a rare find in the marketplace and many buyers will be keen to acquire it as it offers the accommodation that families love.

The home includes an entrance area that leads to a very desirable and extremely generous living and dining area. The main bedroom with an ensuite facility and built in robes is located off the living area. All of these rooms have stunning views.

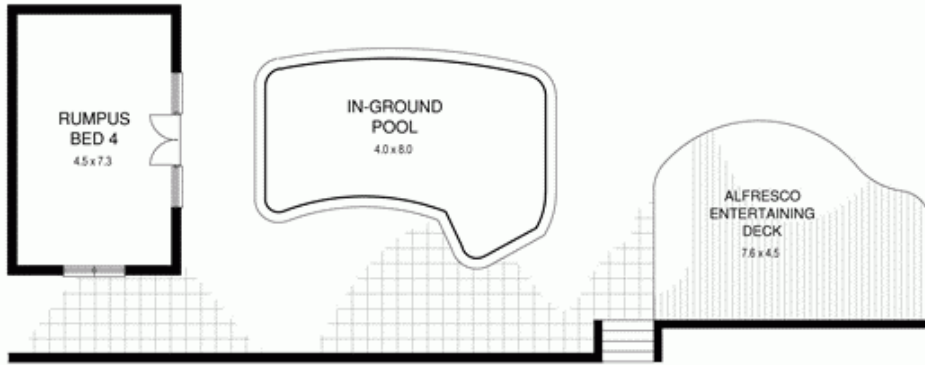

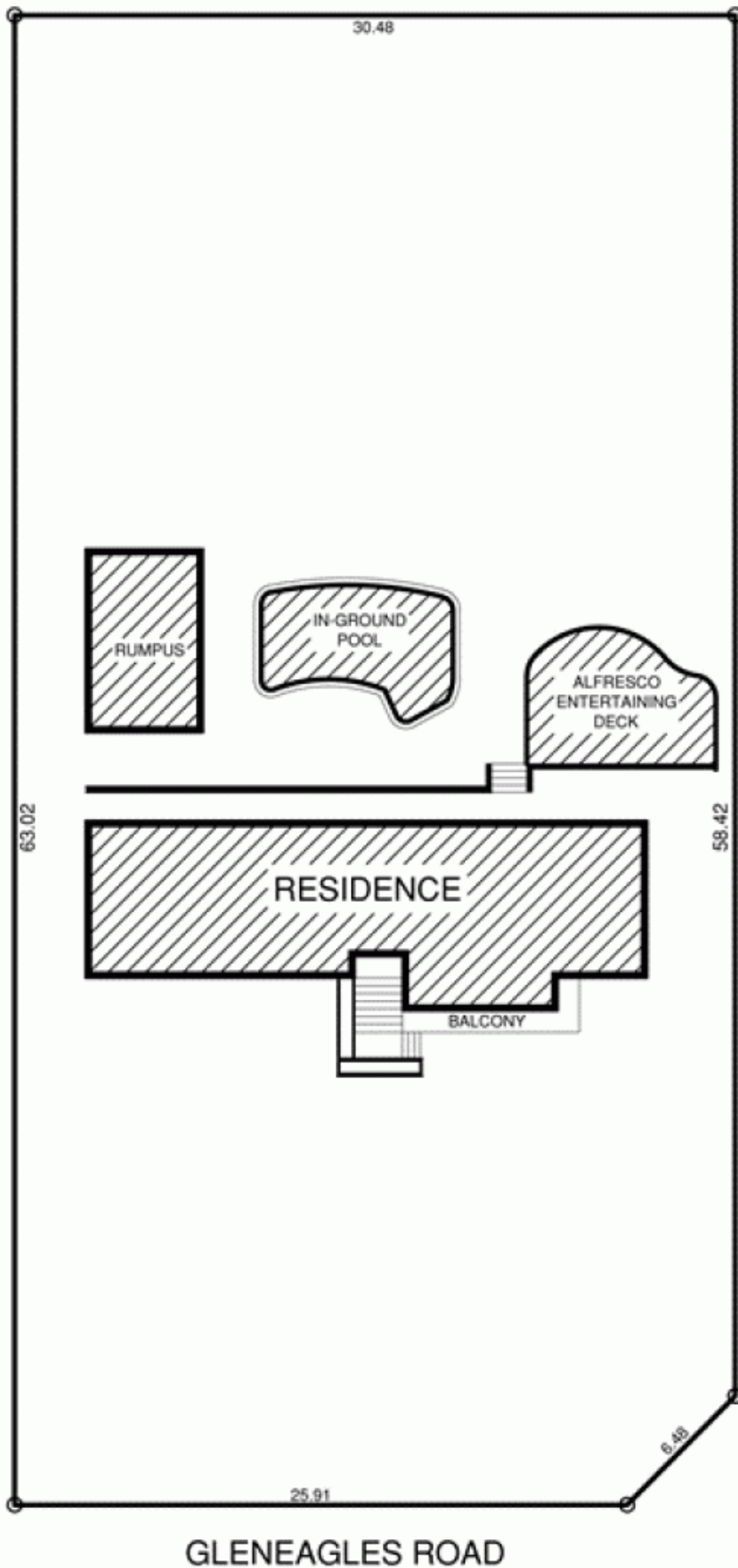

30.48

63.02

58.42

25.91

0.45

GLENEAGLES ROAD

RUMPUS

IN-GROUND
POOL

ALFRESCO
ENTERTAINING
DECK

RESIDENCE

BALCONY