



**3/719 Lower North East Road Paradise SA**

**3**  **2**  **2** 

**ALL THREE HOMES SOLD!**

**READY TO MOVE INTO NOW!**

**YOU WILL BE VERY IMPRESSED WITH THE DESIGNS AND THE SPACIOUS LIVING ROOMS.**

Close to the local shopping centre. Direct bus line to the city or a short walk to the O'Bahn transport link. Enjoy a lovely walk to the Linear Park walking trails one street away. It really is a lovely location to live at!

**DOUBLE LOCK UP GARAGES.**

**2 SEPARATE LIVING AREAS. ONE ON THE LOWER LEVEL AND ONE ON THE UPPER LEVEL.**

**AWESOME KITCHENS.**

**Price** : \$ 500,000

**View** : <https://www.bruse.com.au/sale/sa/north-north-east-suburbs/paradise/residential/house/5549563>



**Theon Bruse**  
**08 8431 8181**



**Toby Shipway**  
**8413 8181**

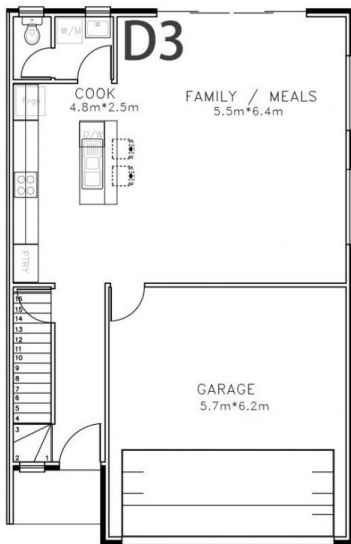

**GROUND FLOOR PLAN**

**Dwelling 3**

**AREAS(sqm)**

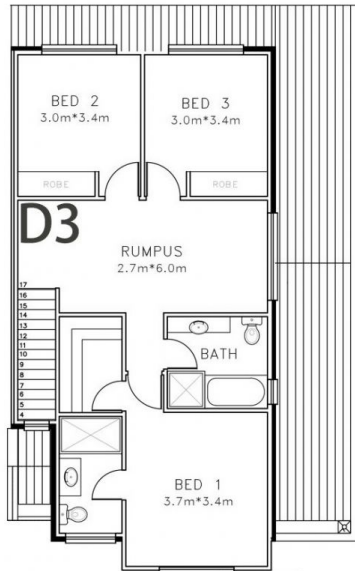

**UPPER FLOOR PLAN**

**Dwelling 3**



GROUND MAIN LIVING	UPPER MAIN LIVING	GARAGE	PORTICO	ALFRESCO	TOTAL
66.34	74.32	36.92	2.90	<sup>14</sup> (APPROX)	194.48

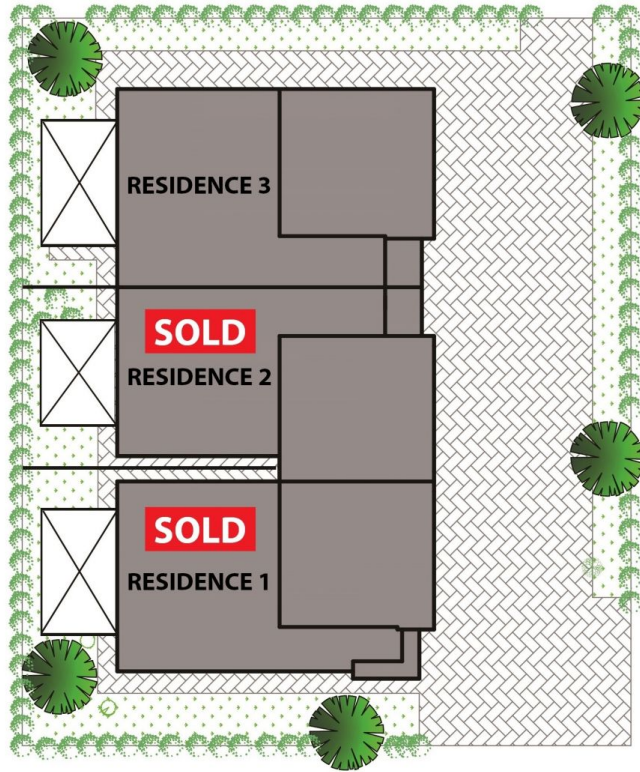

LOWER NORTHEAST RD

