



**13,17 & 18/2 La Scala Court Paradise SA**

**3 2 1**

COME HAVE A LOOK, THESE HOMES HAVE JUST BEEN COMPLETED.

UNBELIEVEABLE VALUE AT \$435,000 - \$440,000

Creative living environments showcasing architectural design elements to suit buyers seeking a quality lifestyle.

Fantastically located adjacent the beautiful Linear Park walking trails and the lovely River Torrens. A tranquil environment to live in with benefits of being only 15 minutes to the CBD. Close by are excellent amenities such as cafes, restaurants and fine food shopping. Education facilities provide a large choice of highly rated Schools and private Colleges.

Transport options include the Paradise Interchange of the

**Price** : \$435,000 - \$440,000

**View** : <https://www.bruse.com.au/5549504>



**Theon Bruse**  
**08 8431 8181**



**Toby Shipway**  
**8413 8181**

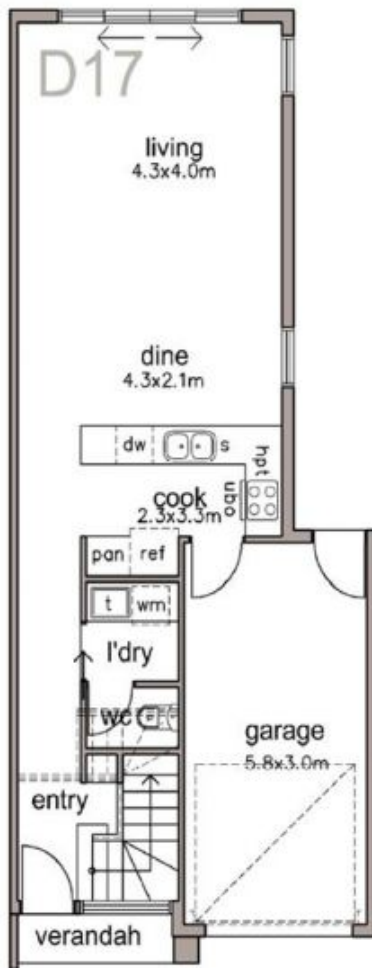

**GROUND FLOOR PLAN**  
DWELLING 17

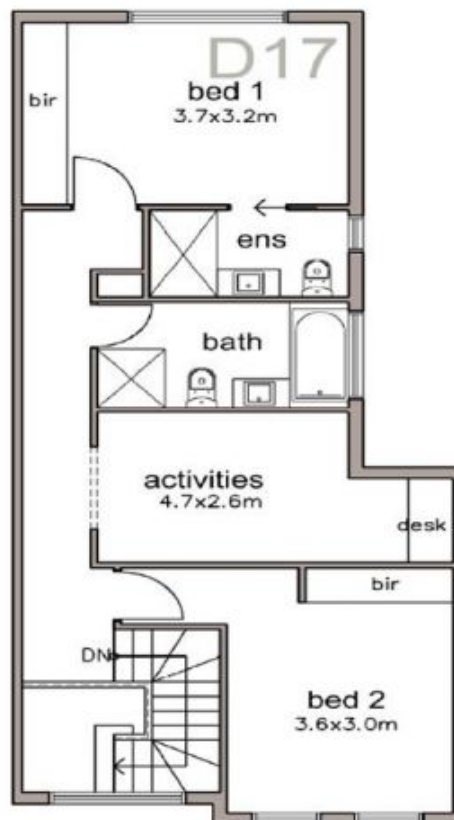

**UPPER FLOOR PLAN**  
DWELLING 17



AREAS (sqm)

GROUND MAIN LIVING	53.00
UPPER MAIN LIVING	72.50
GARAGE	19.50
VERANDAH	2.00
TOTAL	147.00

NOTE: THIS PLAN / DOCUMENT IS FOR ILLUSTRATION PURPOSES ONLY. ALL DIMENSIONS ARE APPROXIMATE. WHILE EVERY ENDEAVOUR HAS BEEN MADE TO VERIFY THE CORRECT DETAILS NEITHER THE VENDOR, THE AGENT, NOR THE DESIGNER ACCEPT LIABILITY FOR ERROR OR OMISSION

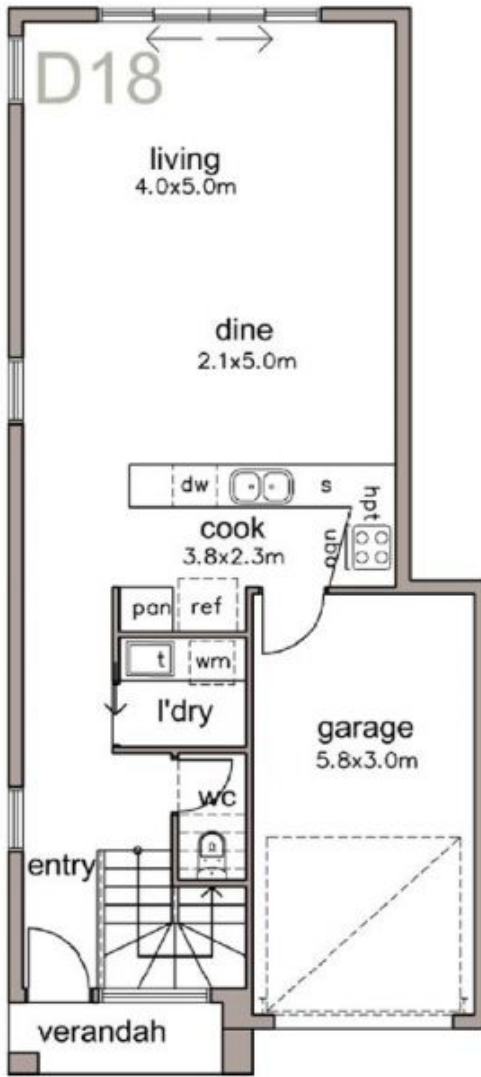

GROUND FLOOR PLAN

DWELLING 18



UPPER FLOOR PLAN

DWELLING 18



AREAS (sqm)

GROUND MAIN LIVING	61.50
UPPER MAIN LIVING	66.00
GARAGE	20.00
VERANDAH	3.00
TOTAL	150.50

NOTE: THIS PLAN / DOCUMENT IS FOR ILLUSTRATION PURPOSES ONLY. ALL DIMENSIONS ARE APPROXIMATE. WHILE EVERY ENDEAVOUR HAS BEEN MADE TO VERIFY THE CORRECT DETAILS NEITHER THE VENDOR, THE AGENT, NOR THE DESIGNER ACCEPT LIABILITY FOR ERROR OR OMISSION